



WASTE OIL DRAIN COLLECTOR

MODEL NO: **AK449D**

Thank you for purchasing a Sealey product. Manufactured to a high standard, this product will, if used according to these instructions, and properly maintained, give you years of trouble free performance.

IMPORTANT: PLEASE READ THESE INSTRUCTIONS CAREFULLY. NOTE THE SAFE OPERATIONAL REQUIREMENTS, WARNINGS & CAUTIONS. USE THE PRODUCT CORRECTLY AND WITH CARE FOR THE PURPOSE FOR WHICH IT IS INTENDED. FAILURE TO DO SO MAY CAUSE DAMAGE AND/OR PERSONAL INJURY AND WILL INVALIDATE THE WARRANTY. KEEP THESE INSTRUCTIONS SAFE FOR FUTURE USE.



Refer to
instructions



Wear eye
protection



Wear protective
gloves

1. SAFETY

- ✓ Use drainer in a suitable work area. Keep area clean and tidy, free from unrelated materials and ensure there is adequate lighting.
- ✓ Ensure the floor is not slippery and wear non-slip shoes.
- ✓ Wear appropriate protective clothing.
- ✓ Keep the drainer clean and in good condition for best and safest performance.
- ✓ Keep children and unauthorised persons away from the work area.
- ✓ Dispose of waste liquids in accordance with local authority regulations.
- ✗ **DO NOT** position drainer in such a way that it will cause potential hazards when moving, holding for draining or storing.
- ☐ **WARNING! DO NOT** allow uncontrolled discharge of fluids thus polluting the environment.

2. INTRODUCTION

Introduction. Mobile waste oil drainer for use with 25L or other suitable containers. Telescopic drain pan with filter grid and ball valve control. Arm fully adjustable in height and depth and fitted with locking nuts for predetermined height selection. Heavy-duty design trolley with handle, two swivel castors and two fixed wheels.

3. SPECIFICATION

Min. Height to Pan:..... 1090mm
Max. Height to Pan:..... 1740mm
Capacity: Dependent on container
Gravity Feed:.....Yes

4. ASSEMBLY

NOTE: Instructions refer to numbers on the parts diagram. You will need a 5mm Allen Key unless otherwise stated.

- 4.1. 3.1. Attach the fixed front wheels (2) to the base plate (4) by inserting the stub axles into the bushes provided. Retain with 5mm hex socket screws.
- 4.2. 3.2. Insert the back wheel caster axles (1) into the bushes provided and retain with 5mm hex socket screws.
- 4.3. 3.3. Slide the clamping set (5) onto the handle (6) and insert the handle into the socket at the rear of the base plate. Retain the handle by tightening the 5mm hex socket grub screw to be found in the side of the socket on the underside of the base plate.
- 4.4. 3.4. Slide the square tube clamp set (7) into the clamping set (5) and tighten the retaining knob.
- 4.5. 3.5. Slide the oil pipe (10) through the square tube clampset (7) and tighten the retaining knob.
- 4.6. 3.6. Slide the height selection rings (12) over the bottom end of the oil pipe and lock them in the required position by tightening the two hex socket grub screws using a 4.5mm Allen key.
- 4.7. 3.7. Insert the outlet of the oil pan into the top of the ball valve assembly. Ensure that it is fully seated and retain it by tightening the 5mm hex socket screw in the side of the collar. The oil pan is not gripped by the fixing and can be rotated through 360° as indicated in fig.1.

5. OPERATING INSTRUCTIONS

5.1. Collection of waste oil.

- 5.1.1. The AK449D is designed for use with 25L drums or similar containers that will fit onto the base plate. If a container laps over the edge of the base do not use it.
- 5.1.2. The AK449D has a number of adjustments that allow the drainer to adapt to different sizes of containers and different workshop conditions. The overall height of the unit can be adjusted using a combination of clamps (C) and (E) as shown in fig.1. The centreline of the oil pipe and pan can be adjusted using clamp (F) and the oil pan will rotate through 360°.
- 5.1.3. If a task is repeated often using the same container and/or vehicle, the set up can be easily repeated by using the locking rings (D) to mark the position of the oil pipe in relation to the clamp (C).
- 5.1.4. Loosen the oil pipe clamp (fig.1-C) and raise the pipe and pan to clear the chosen container. The container must rest flat and level on the base. Adjust the height of the oil pipe and pan so that the drainer will pass under the raised vehicle.
- 5.1.5. Adjust the height and positioning of the unit below the sump drain point. To allow the oil to pass directly into the container open the ball valve as shown in fig.1-B. When the container becomes full after a number of draining operations the ball valve can be shut whilst changing the container.
- 5.1.6. Do not move the unit with oil still in the pan. Always ensure that any oil is drained down to the lower container before moving the unit.

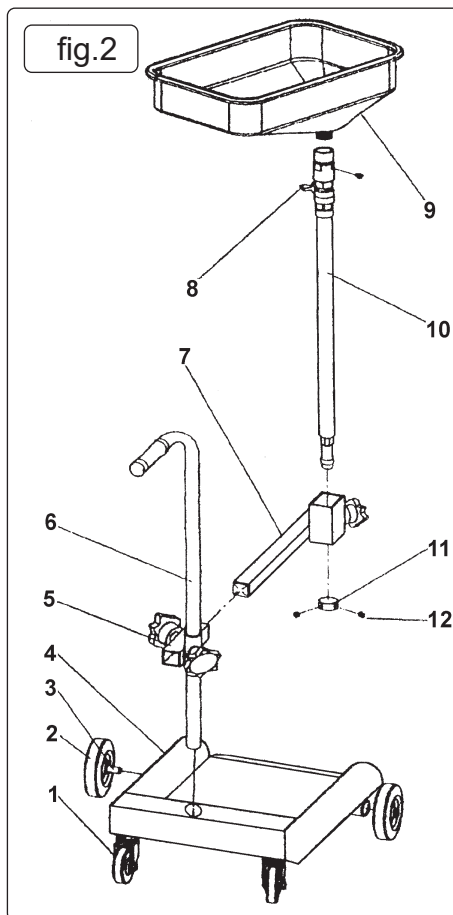
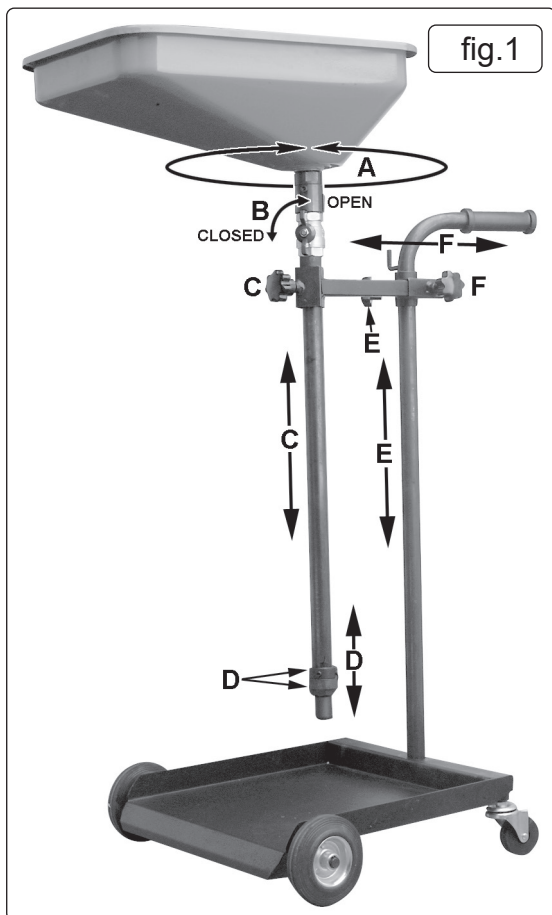

ENVIRONMENT PROTECTION

Recycle unwanted materials instead of disposing of them as waste. All tools, accessories and packaging should be sorted, taken to a recycling centre and disposed of in a manner which is compatible with the environment. When the product becomes completely unserviceable and requires disposal, drain any fluids (if applicable) into approved containers and dispose of the product and fluids according to local regulations.

Note: It is our policy to continually improve products and as such we reserve the right to alter data, specifications and component parts without prior notice.

Important: No Liability is accepted for incorrect use of this product.

Warranty: Guarantee is 12 months from purchase date, proof of which is required for any claim.



REGISTER YOUR
PURCHASE HERE

Jack Sealey Ltd t/a Sealey Group, Kempson Way, Suffolk Business Park, Bury St Edmunds, Suffolk, IP32 7AR UK

Jack Sealey (EU) Ltd t/a Sealey Group, Farney Street, Carrickmacross, Co. Monaghan, A81 PK68 Ireland

Tel: 01284 757500 • Email: sales@sealey.co.uk • Web: www.sealey.co.uk